



## What is good about it?

- Tuned valve system
- Robust yet, light weight
- Integral oiler – provides continuous lubrication
- Four-bolt backhead – withstands rugged use

## Where it is used?

- Light demolition of floors, pavement and masonry walls
- Breaking of frozen ground
- Bridge deck jobs

## Specification

Model #	RMT 0112 EXT	
Weight	16 kg	35 lb
Length	800 mm	31.5"
Air pressure	6 bar	87 psi
Air consumption	23 l/s	49 cfm
Blows per minute	1620	
Air inlet	19 mm	¾"
Shank size (standard) - 8900 0030 25, 8900 0030 23	25 x 108 mm	1" x 4¼"
Retainer type	Latch	

15th Oct 2020 | RMT 100.01.07



Working Tools



Lubricator

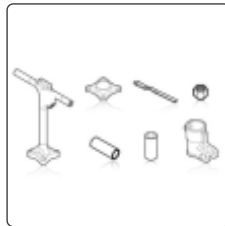

Spare Parts

